



INSTALLATION MANUAL

Severn 5030 (28mm)

Log Cabin

E9 - 5030SPP (28)

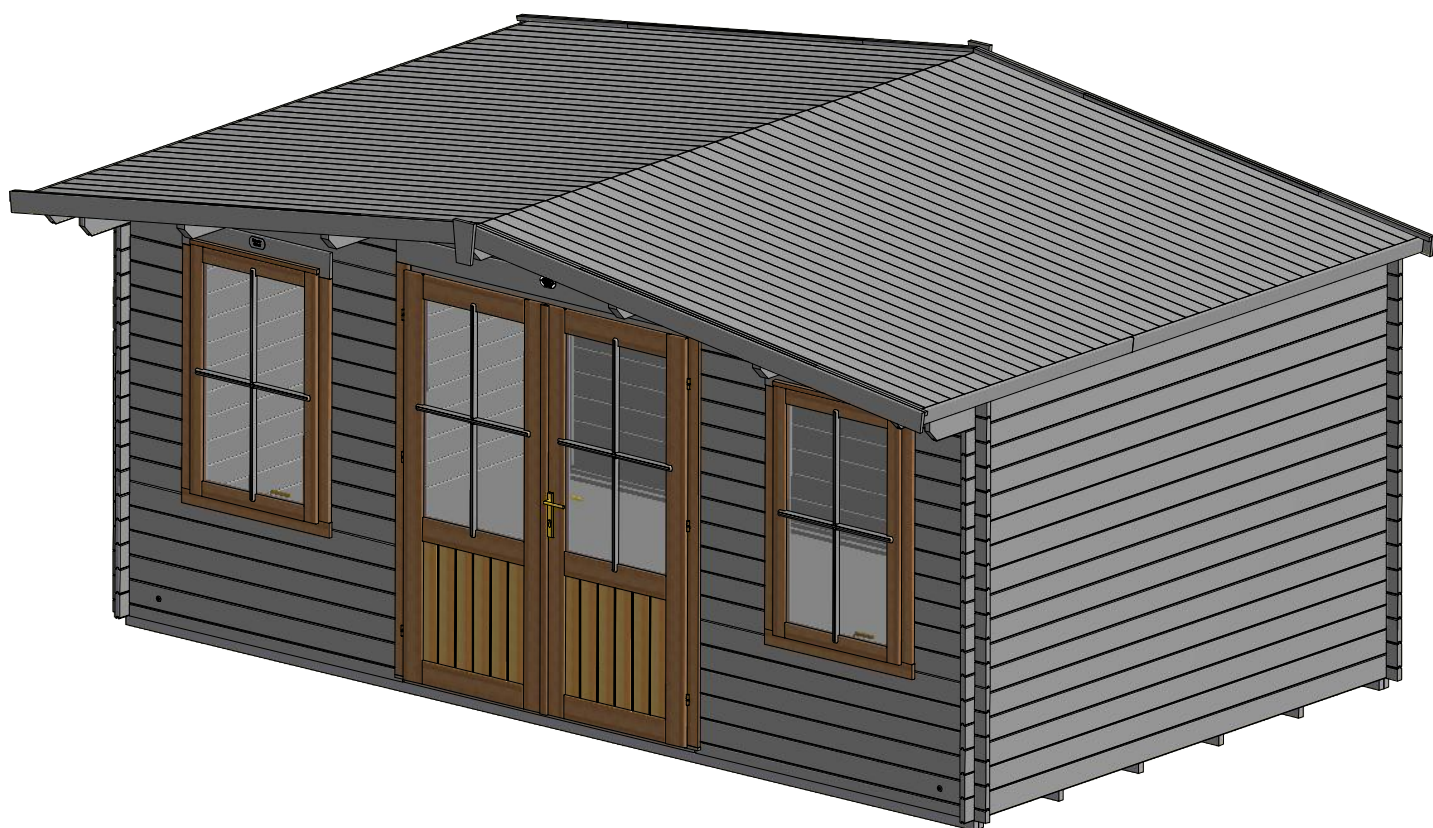

Important!

If you have bought shingles, please use our provided shingle installation instructions.

Unique Cabin Reference Number.

www.dunsterhouse.co.uk

Component details for Severn 50/30 (28)

EN.4860

8 of required
Bearers
(Pressure treated)

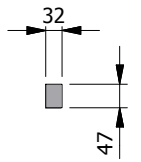
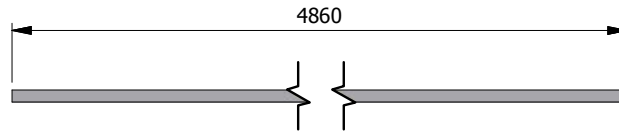

A28.435.70.0.0

22 of required
Wall log

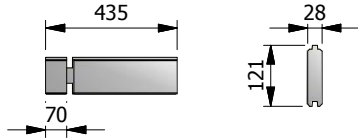

A28.435.0.0.0

22 of required
Wall log

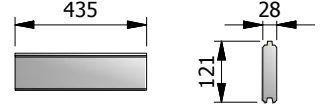

A28.1660.70.0.0

12 of required
Wall log

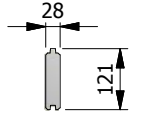
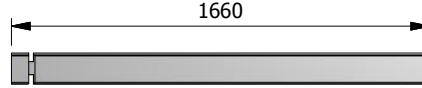

A28.3000.70.70.0

32 of required
Wall log

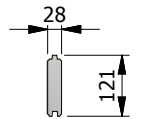
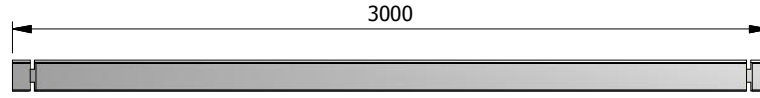

A28.3250.70.320.0

2 of required
Wall log

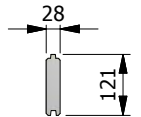
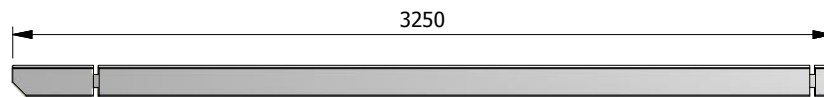

A28.5000.70.70.0

18 of required
Wall log
(Inc. one spare)

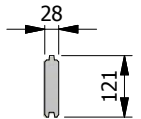
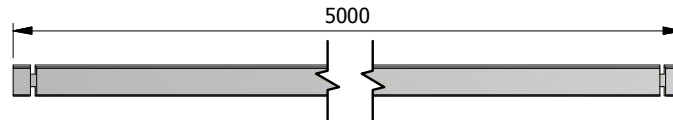

B28.1660.70.0.0

2 of required
Bottom wall log

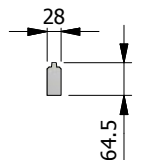
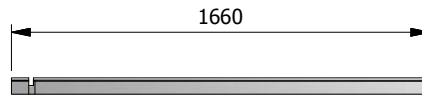

B28.5000.70.70.0

1 of required
Bottom wall log

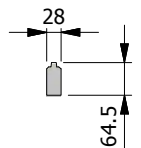
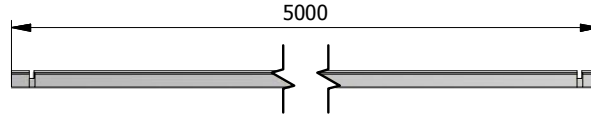

HN.2000

4 of required
Eaves edging
Required to be cut on site

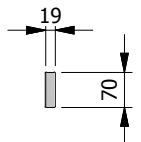
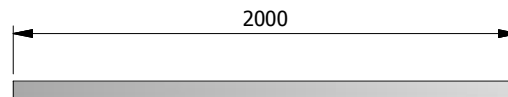

J.3000

8 of required
Floor trims
Required to be cut on site

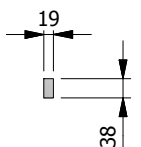
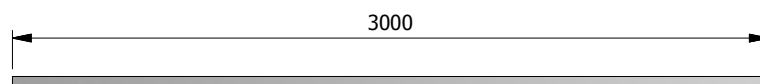

Component details for Severn 50/30 (28)

J.1960.A

4 of required
Storm brace

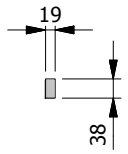
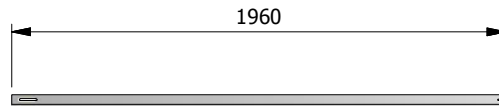

N.1960

12 of required
Apex trims and wind brace
Required to be cut on site

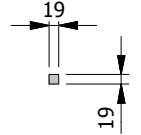
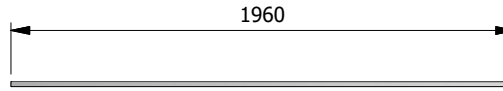

P45.3500.65.565.0

1 of required
Purlin

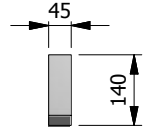
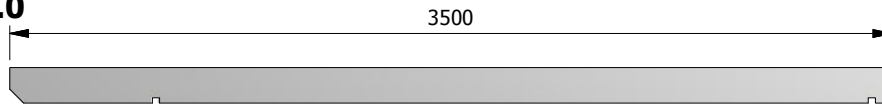

P45.8L.3500.65.565.0

2 of required
Purlin

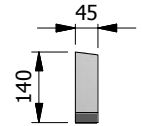
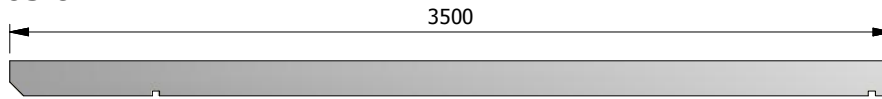

P45.8R.3500.65.565.0

2 of required
Purlin

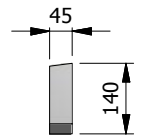
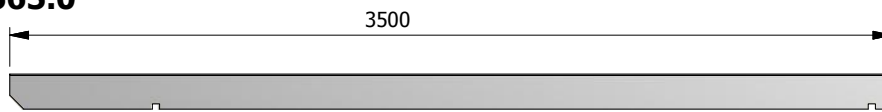

XN28.8L.3500.70.570.0

1 of required
Top wall log

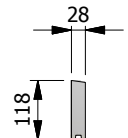
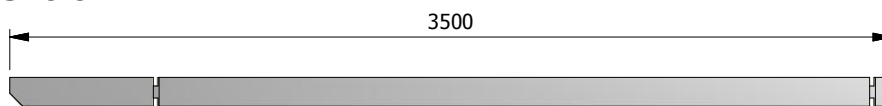

XN28.8R.3500.70.570.0

1 of required
Top wall log

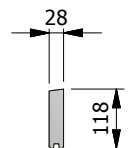
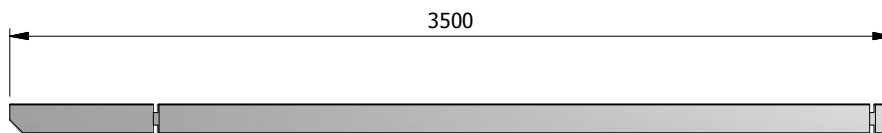

ZN.2640.C8

4 of required
Fascia board

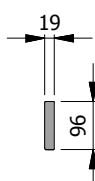
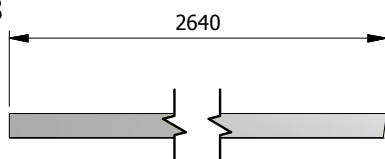

Z.195.A

2 of required
Trapezoid

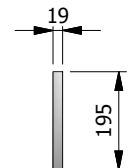
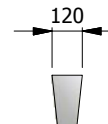

Component details for Severn 50/30 (28)

F.2570

80 of required
Roof Board

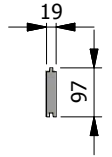
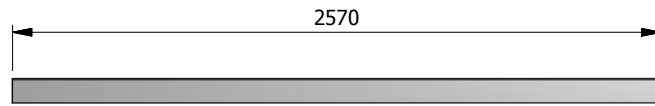

F.2770

54 of required
Floor Board
(Inc. one spare)

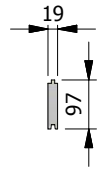
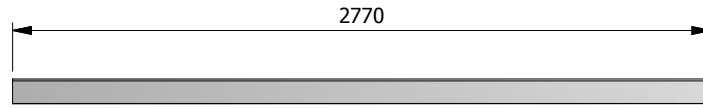

AP.28.5000

2 of required
Apex

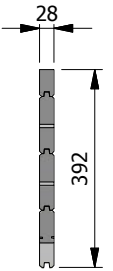
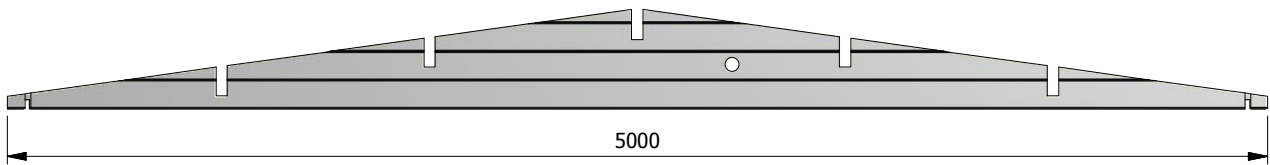

E9 - Double Door

1 of required



E9 - Window assembly

2 of required

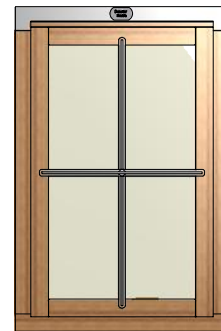

ACCESSORIES	
ITEM	QTY
35mm screw for securing door to first 3 wall logs, wind braces, apex trims, roof edge reinforcements, eaves edging, trapezoid, SMB brackets	180
50mm screws for fascias and double bearers	35
55mm screws for floor trims	35
70mm screws for first logs, door frame and purlins	60
M6 x 60mm bolts and nuts for storm braces	8
M6 25mm washers for storm braces	16
20mm screws for vents	9
40mm nails for floor and roof boards	860
Set of vents	2
Door handle set and accessories	1
Window handle set and accessories	2
SMB075 (28) Interlocking Window to Log Connecting brackets	16
SMB077 (28) Intelocking Door to Log Connecting Brackets	16
Installation manual	1
Generic Assembly Instructions	1

Bearer Layout for Severn 50/30

Log Cabin Bearer Layout Severn 50/30

We suggest preparing minimum overall base dimension of 5060x3060mm

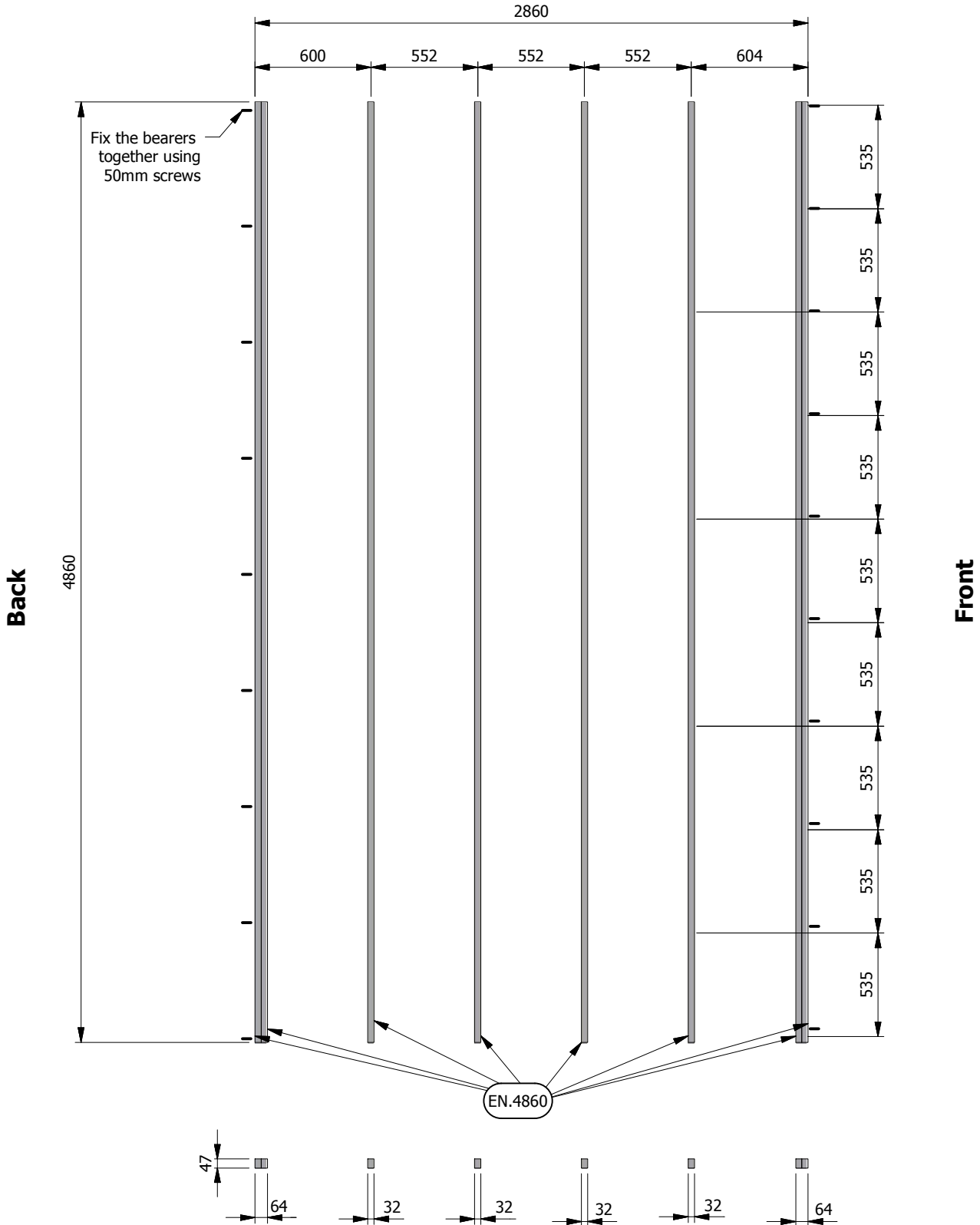

Wall Layout for Severn 50/30 (28mm)

Front Wall

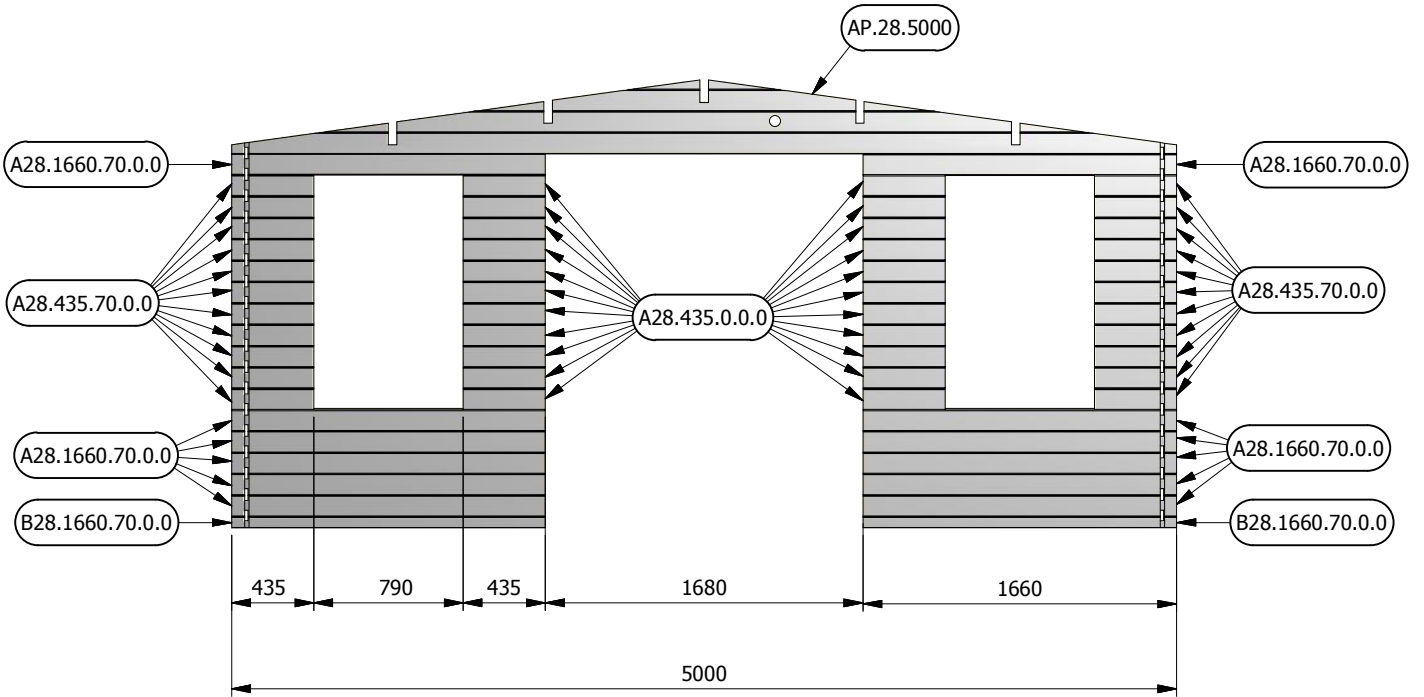

Rear Wall

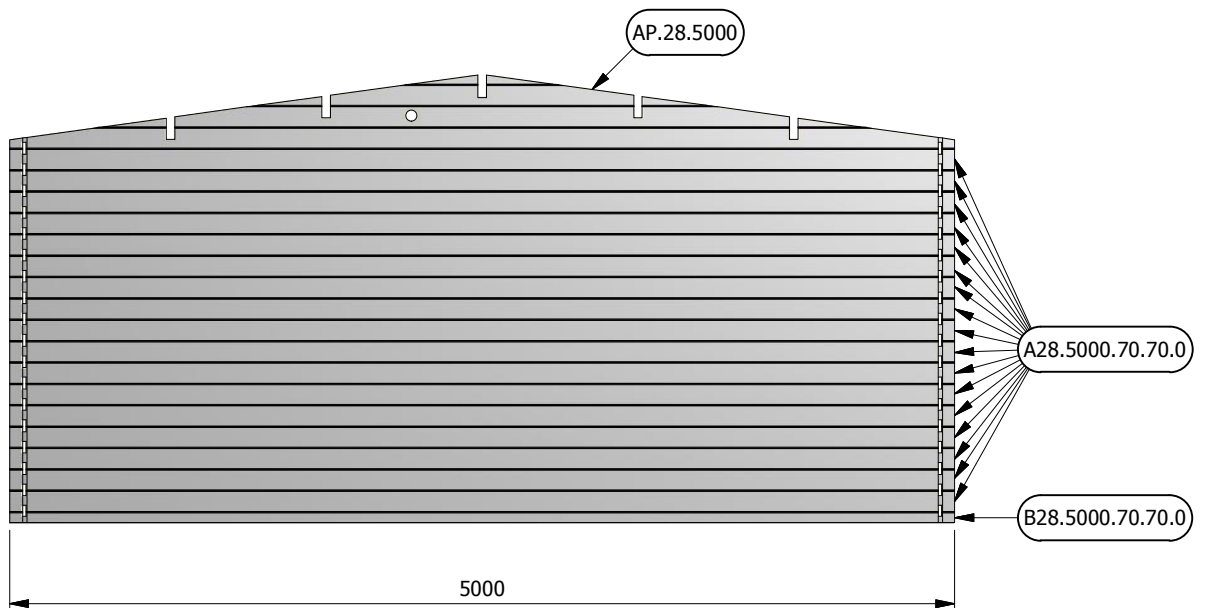

Wall Layout for Severn 50/30 (28mm)

Side Wall

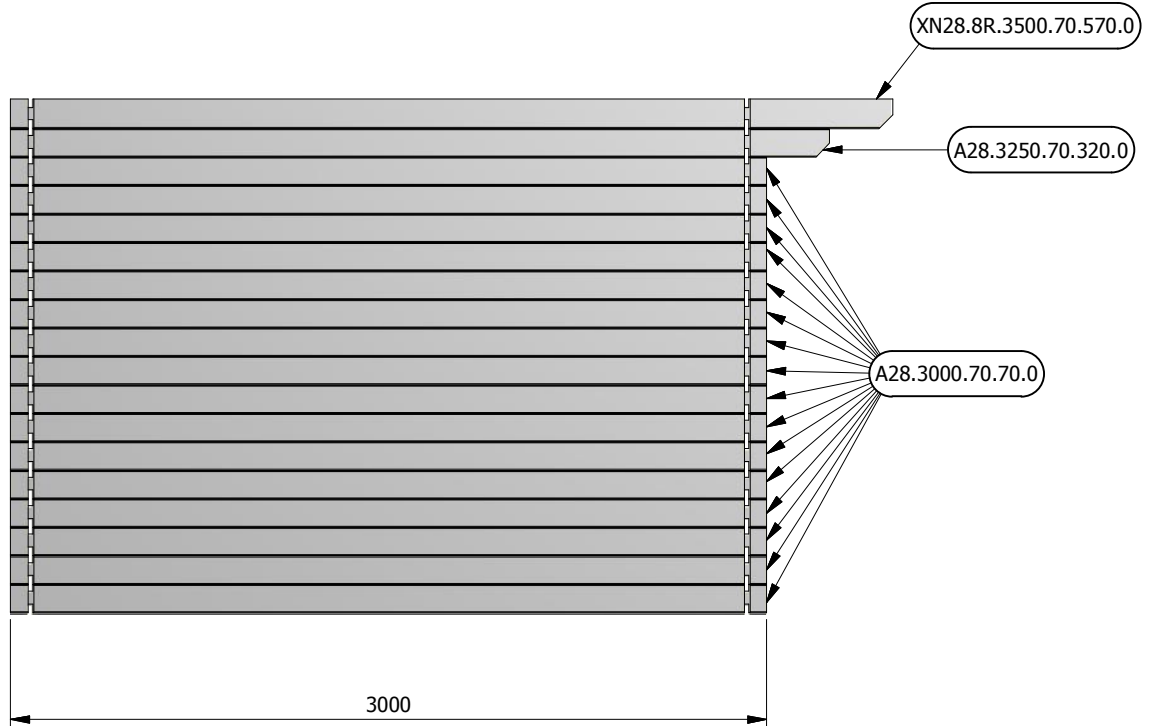

Side Wall

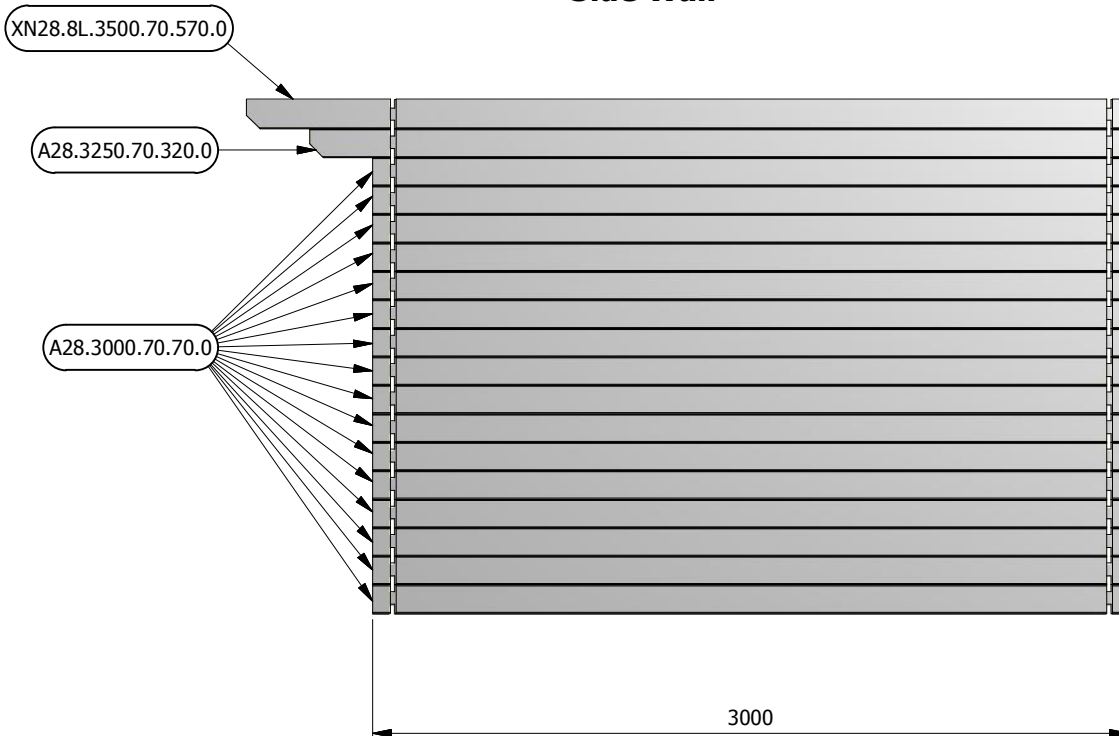

Purlin and Roof Installation for Severn 50/30 (28mm)

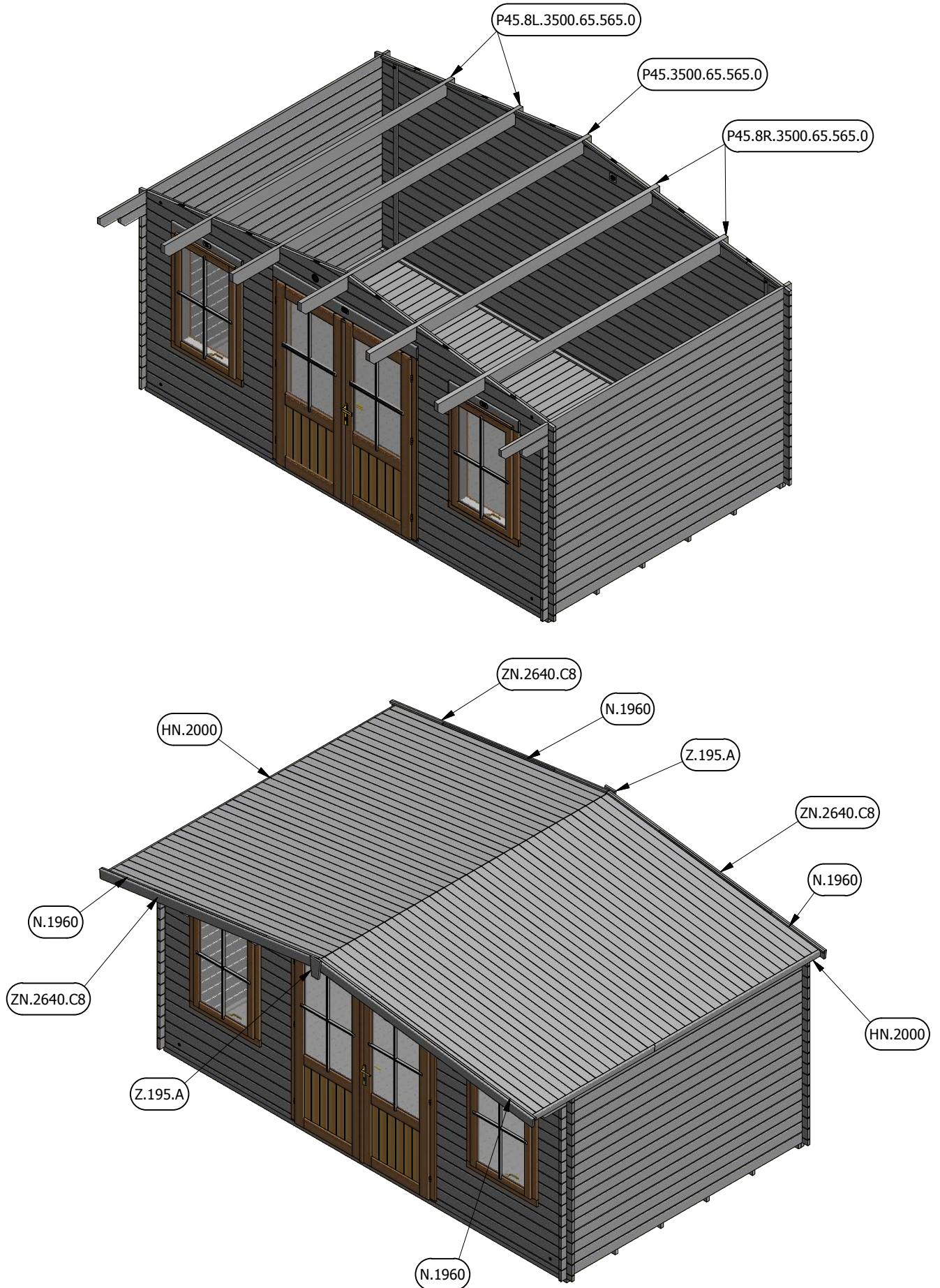

Roof Insulation Panel Layout for Premium Plus Severn 50/30

Rear Elevation

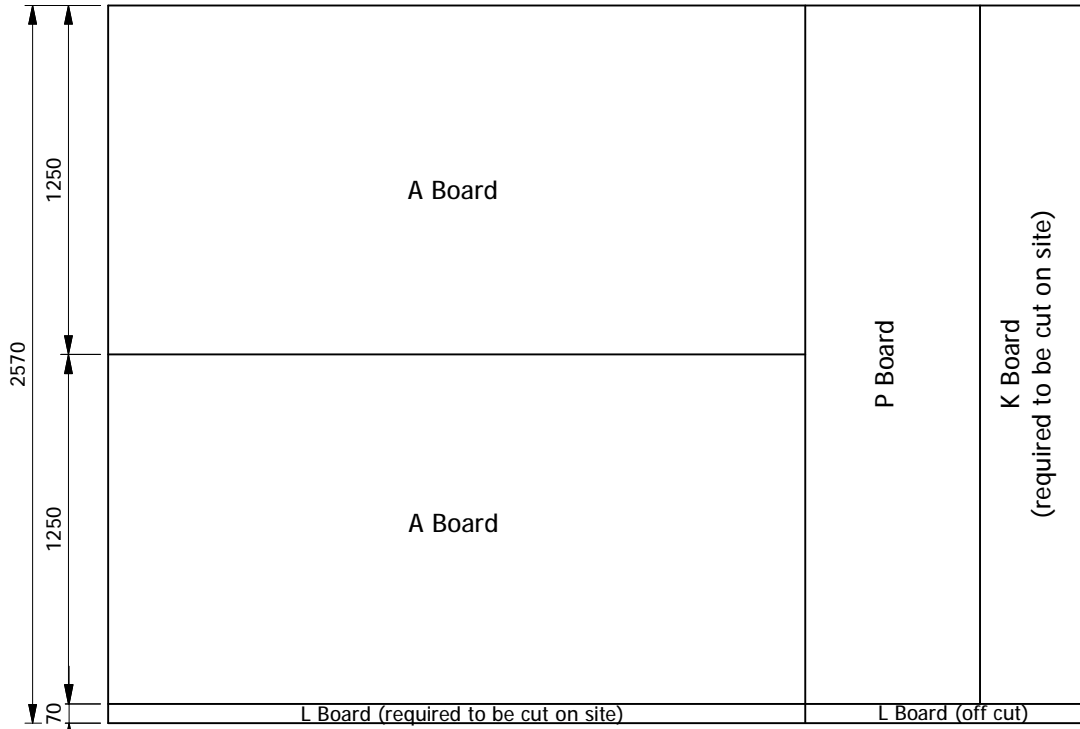

Front Elevation

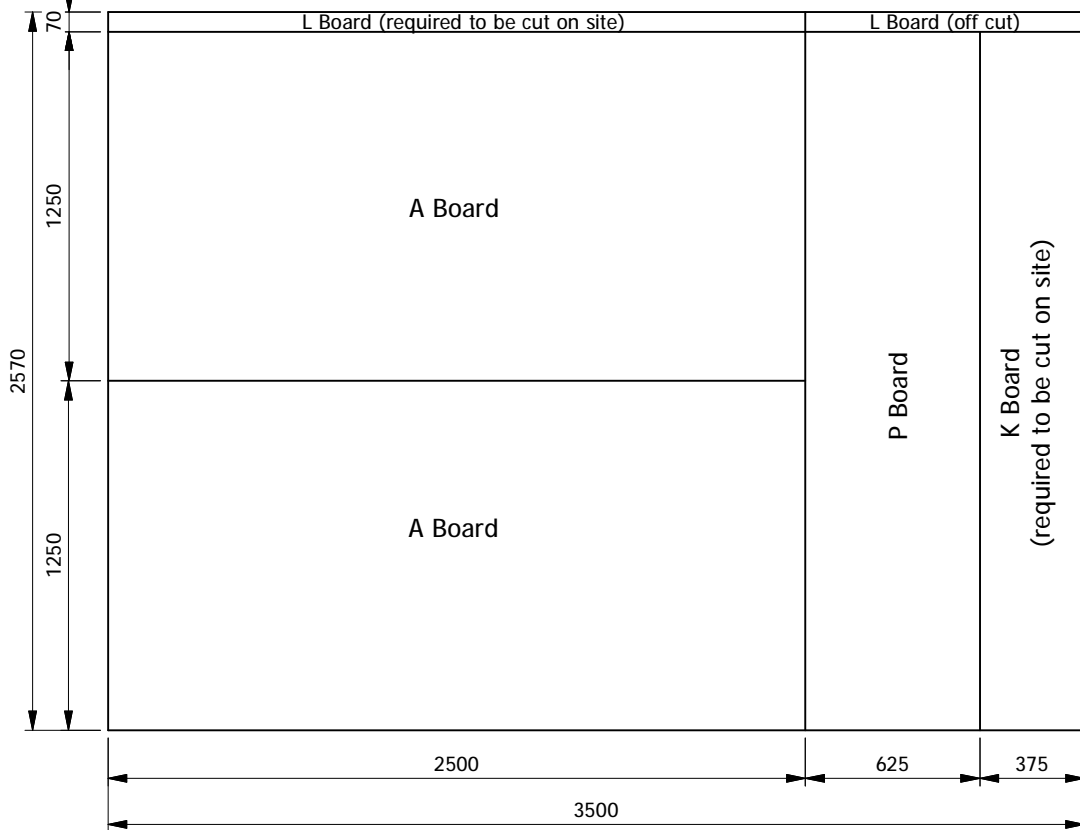

INSULATION BOARDS	
Description	Qty
Panel A (1250x2500mm)	4
Panel P (625x1250mm)	2
Panel K (415x2500mm)	2
Panel L (155x1250mm)	2

SCREWS AND METAL BRACKETS	
Description	Qty
Diameter 3x50mm Screws for roof insulation	170
Diameter 3x20mm Screws for metal brackets	50
Metal brackets	12